

### SUBJECT PROPERTY SIGNIFICANT TREES

TREE #	SPECIES	DBH (IN.)	HT. (FT.)	CONDITION	TPZ RADIUS (FT)	RETAIN (Y/N)
<b>(35' WETLANDS BUFFER)</b>						
1081	BIGLEAF MAPLE	21.7	60	FAIR/ POOR	-	NO (IMPACT)
1161	BIGLEAF MAPLE	33.2	85	GOOD	20	YES
1160	BIGLEAF MAPLE	13.7	60	GOOD	14	YES
1163	BIGLEAF MAPLE	6.4	25	FAIR/ POOR	7	YES
1164	BIGLEAF MAPLE	20.9	70	GOOD/ FAIR	17	YES
1158	RED ADLER	20.0	25	VERY POOR	-	NO (HAZARD)
01	BIGLEAF MAPLE	6.2	40	GOOD	-	NO (IMPACT)
1156	BIGLEAF MAPLE	23.1	70	FAIR	-	NO (EXC FP)
1155	BIGLEAF MAPLE	7.6	40	FAIR	-	NO (EXC FP)
1246	BIGLEAF MAPLE	9.0	50	GOOD/ FAIR	-	NO (EXC FP)
1244	RED ADLER	19.7	70	GOOD	15	YES
1337	RED ADLER	23.0	75	GOOD/ FAIR	-	NO (EXC FP)
1367	BIGLEAF MAPLE	10.1	55	FAIR	-	NO (EXC FP)
1358	BIGLEAF MAPLE	36.8	100	GOOD/ FAIR	-	NO (EXC FP)
1357	BIGLEAF MAPLE	18.4	70	GOOD/ FAIR	-	NO (IMPACT)
1345	BIGLEAF MAPLE	44.3	100	GOOD/ FAIR	-	NO (IMPACT)
1346	WESTERN HEMLOCK	18.1	60	GOOD/ FAIR	14	YES
02	BIGLEAF MAPLE	7.1	20	FAIR	14	YES
1356	PACIFIC DOGWOOD	10.6	40	FAIR	-	NO (IMPACT)
1351	BIGLEAF MAPLE	9.3	40	GOOD/ FAIR	-	NO (IMPACT)
03	BIGLEAF MAPLE	6.7	35	GOOD	16	YES
1447	BIGLEAF MAPLE	10.0	40	GOOD	17	YES
<b>(WETLANDS)</b>						
1241	RED ADLER	20.5	60	FAIR/ POOR	17	YES
04	BIGLEAF MAPLE	18.1	65	GOOD/ FAIR	14	YES
1242	RED ADLER	13.8	65	FAIR/ POOR	11	YES
1243	WESTERN HEMLOCK	15.7	70	FAIR	11	YES
1338	RED ADLER	20.2	70	GOOD/ FAIR	-	NO (EXC FP)
1339	BIGLEAF MAPLE	12.0	65	GOOD/ FAIR	22	YES
1340	RED ADLER	21.4	70	FAIR	24	YES
1341	BIGLEAF MAPLE	13.0	60	GOOD/ FAIR	22	YES
1344	RED ADLER	17.2	65	GOOD/ FAIR	28	YES
<b>ENCROACHING ADJACENT PROPERTY SIGNIFICANT TREES</b>						
A	WESTERN RED CEDAR	26	70	GOOD	20	YES
B	WESTERN HEMLOCK	22	80	GOOD/ FAIR	22	YES
C	BIGLEAF MAPLE	16	50	FAIR	12	YES
D	BIGLEAF MAPLE	17	70	GOOD/ FAIR	13	YES
E	BIGLEAF MAPLE	40	-	-	30	YES
1413	BIGLEAF MAPLE	42	100	GOOD	21	YES
1159	RED ADLER	20	-	-	20	YES
<b>R.O.W. SIGNIFICANT TREES</b>						
1079	BIGLEAF MAPLE	20.1	60	GOOD/ FAIR	-	NO (IMPACT)
1082	BLACK COTTONWOOD	41.9	110	GOOD	-	NO (IMPACT)

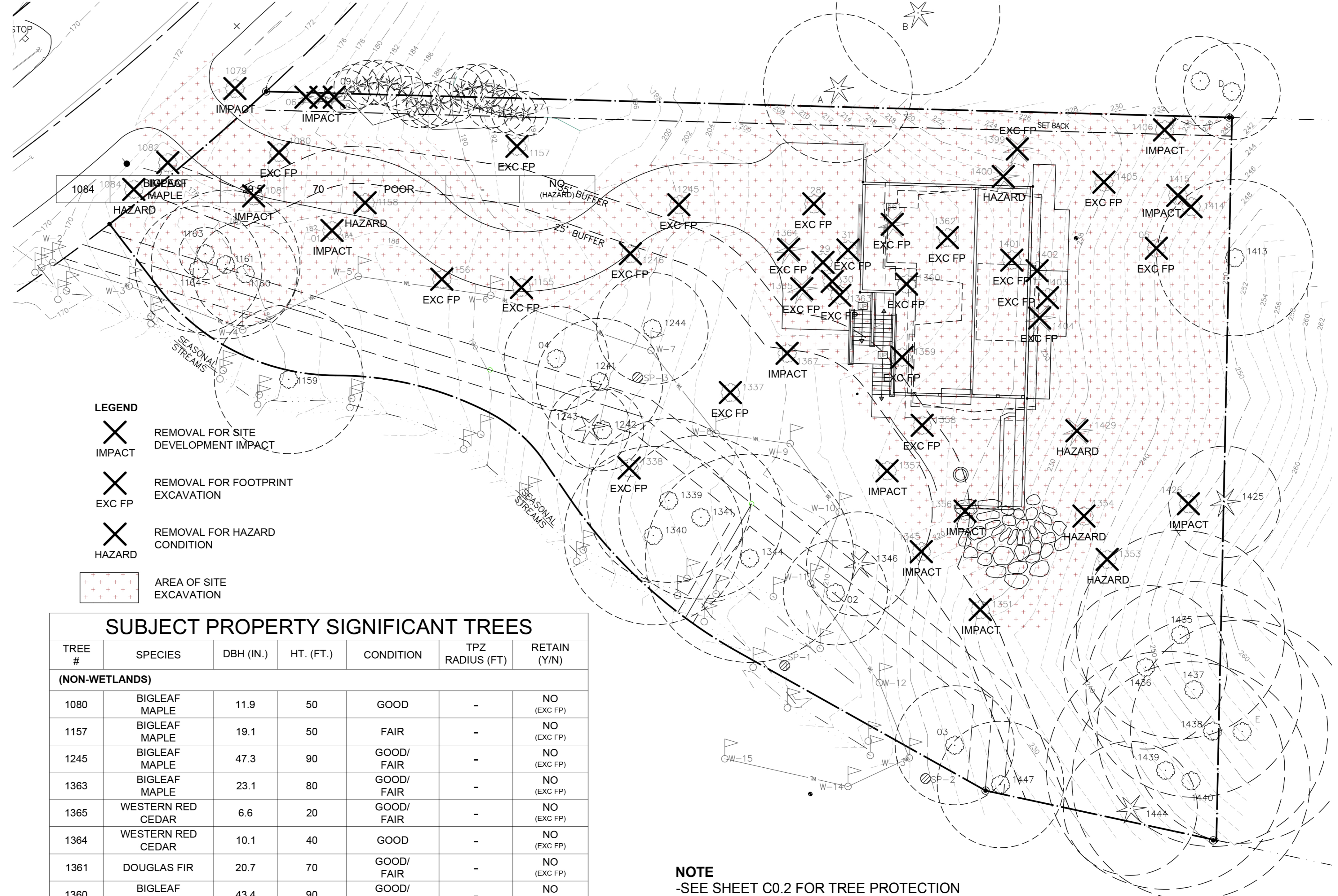

**LEGEND**

- REMOVAL FOR SITE DEVELOPMENT IMPACT
- REMOVAL FOR FOOTPRINT EXCAVATION
- REMOVAL FOR HAZARD CONDITION
- AREA OF SITE EXCAVATION

### SUBJECT PROPERTY SIGNIFICANT TREES

TREE #	SPECIES	DBH (IN.)	HT. (FT.)	CONDITION	TPZ RADIUS (FT)	RETAIN (Y/N)
<b>(NON-WETLANDS)</b>						
1080	BIGLEAF MAPLE	11.9	50	GOOD	-	NO (EXC FP)
1157	BIGLEAF MAPLE	19.1	50	FAIR	-	NO (EXC FP)
1245	BIGLEAF MAPLE	47.3	90	GOOD/ FAIR	-	NO (EXC FP)
1363	BIGLEAF MAPLE	23.1	80	GOOD/ FAIR	-	NO (EXC FP)
1365	WESTERN RED CEDAR	6.6	20	GOOD/ FAIR	-	NO (EXC FP)
1364	WESTERN RED CEDAR	10.1	40	GOOD	-	NO (EXC FP)
1361	DOUGLAS FIR	20.7	70	GOOD/ FAIR	-	NO (EXC FP)
1360	BIGLEAF MAPLE	43.4	90	GOOD/ FAIR	-	NO (EXC FP)
1359	BIGLEAF MAPLE	12.8	70	FAIR	-	NO (EXC FP)
1362	BIGLEAF MAPLE	12.1	60	GOOD/ FAIR	-	NO (EXC FP)
1400	WESTERN HEMLOCK	10.5	40	POOR	-	NO (CONDITION)
1399	WESTERN HEMLOCK	10.0	40	GOOD/ FAIR	-	NO (EXC FP)
1401	BIGLEAF MAPLE	10.8	50	GOOD/ FAIR	-	NO (EXC FP)
1402	BIGLEAF MAPLE	37.4	75	FAIR	-	NO (EXC FP)
1403	BIGLEAF MAPLE	39.4	85	GOOD/ FAIR	-	NO (EXC FP)
1404	WESTERN HEMLOCK	8.0	40	GOOD/ FAIR	-	NO (EXC FP)
1405	BIGLEAF MAPLE	23.3	80	GOOD/ FAIR	-	NO (EXC FP)
1406	BIGLEAF MAPLE	38.6	90	GOOD/ FAIR	-	NO (IMPACT)
1415	BIGLEAF MAPLE	11.6	20	FAIR/ POOR	-	NO (IMPACT)
1414	BIGLEAF MAPLE	28.9	90	FAIR	-	NO (IMPACT)
05	BIGLEAF MAPLE	7.6	30	GOOD/ FAIR	-	NO (EXC FP)
1429	WESTERN HEMLOCK	16.0	55	FAIR/ POOR	-	NO (HAZARD)
1354	BIGLEAF MAPLE	47.3	50	POOR	-	NO (HAZARD)
1353	BIGLEAF MAPLE	34.7	75	FAIR/ POOR	-	NO (HAZARD)
1426	BIGLEAF MAPLE	48.9	90	FAIR	-	NO (IMPACT)

**NOTE**  
-SEE SHEET C0.2 FOR TREE PROTECTION

### SUBJECT PROPERTY SIGNIFICANT TREES

TREE #	SPECIES	DBH (IN.)	HT. (FT.)	CONDITION	TPZ RADIUS (FT)	RETAIN (Y/N)
1425	WESTERN HEMLOCK	14.6	60	FAIR	15	YES
1435	BIGLEAF MAPLE	26.2	90	GOOD/ FAIR	28	YES
1437	BIGLEAF MAPLE	34.7	90	GOOD	29	YES
1438	BIGLEAF MAPLE	28.5	90	GOOD/ FAIR	31	YES
1436	BIGLEAF MAPLE	10.2	30	GOOD/ FAIR	22	YES
1439	BIGLEAF MAPLE	41.1	90	GOOD/ FAIR	32	YES
1440	BIGLEAF MAPLE	41.5	90	GOOD/ FAIR	32	YES
1444	WESTERN RED CEDAR	19.1	50	GOOD	18	YES
06-08	LEYLAND CYPRESS	4	15-20	GOOD/ FAIR	-	NO (IMPACT)
09-27	LEYLAND CYPRESS	3.5-5.5	15-20	GOOD/ FAIR	6	YES
28	WESTERN RED CEDAR	5.2	25	GOOD/ FAIR	-	NO (EXC FP)
29	WESTERN RED CEDAR	2.8	20	GOOD/ FAIR	-	NO (EXC FP)
30	WESTERN RED CEDAR	1.9	15	GOOD/ FAIR	-	NO (EXC FP)
31	WESTERN RED CEDAR	2.1	12	GOOD/ FAIR	-	NO (EXC FP)

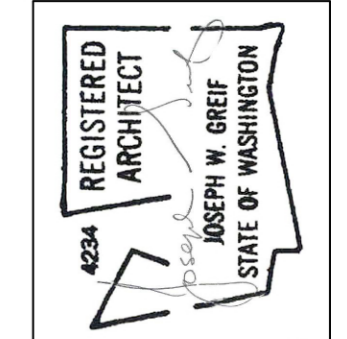
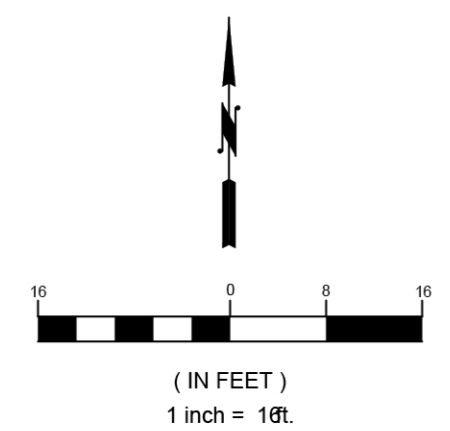

**JOSEPH GREIF ARCHITETS**  
921 NE Boat Street, Seattle, WA 98105  
www.greifarchitects.com  
T: 206 633 4293  
F: 206 633 3735

PLOT DATE: OCT-2017  
DRAWN BY: JA, JG  
PURPOSE: PERMIT  
PROJ. NO: 2017.MILLS  
CHECKED BY: JG

REVISIONS:  
△ DATE:  
△ DATE:

**PERMIT SET**

**MERCER ISLAND RESIDENCE**  
5236 W MERCER WAY  
MERCER ISLAND, WA 98125

**GENERAL INFORMATION**  
ARBORIST PLAN  
TREES INFO

SHEET NO. **A0.4**